

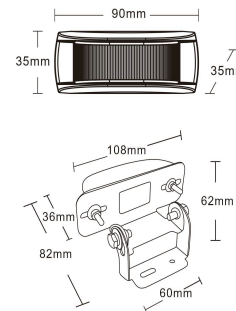

# CORNER 180° STROBE, CLEAR LENS, 12 AMBER LEDs, 2 BOLT BRACKET MOUNT

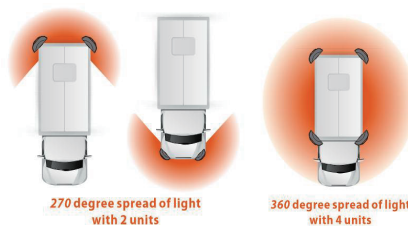

Part #: **WB-42401-A**



- Approval: ECE R65 XA1 (amber or clear lens) & ECE R65 XB1 (blue or clear lens)  
ECE R65 HTA1 (amber or clear lens) & ECE R65 HTB1 (blue or clear lens)  
ECE R65 TA2 (amber or clear lens) & ECE R65 TB2 (blue or clear lens)  
CE, UKCA, ECE R10

Meets: SAE J845 Class 1 (with 2 or 4 units, amber or clear lens), CISPR25 Class 3

## Specification:

- \*1 unit offer a 180 degree approved to ECE R65 XA1 & XB1.
- \*2 units offer a 270 degree approved to ECE R65 HTA1&HTB1.
- \*4 units offer a full 360 degree approved to ECE R65 TA2&TB2.
- \*Available in clear or coloured lens (Blue and Amber).
- \*Operating Voltage: DC 12-24V
- \*12 LED\*3W
- \*Max Qty of SYNC'D Heads: 14 units
- \*Multi-units synchronization in simultaneous or alternating flash.
- \*19 Flash patterns
- \*With memory function
- \*2 Bolts & Bracket installation are available
- \*Weatherproof and vibration resistant design for external or internal use.
- \*Meets IP67/IP69K ingress protection standards
- \*-30° C to +60° C extreme temperature reliability



## WARNING

- (1) Do not look directly into LEDs while in operation; may cause momentary blindness and/or eye damage.
- (2) It is mandatory to use ECE R65 certified flash patterns on public roads; while other flash patterns can be used only when it is permitted.

## Flash Patterns:

#1	Single flash (ECE R65)	#11	Double flash - Slow
#2	Double flash (ECE R65, SAE)	#12	Triple flash
#3	Quad flash (ECE R65)	#13	Quad flash - Slow
#4	Octa flash	#14	Octa flash - Slow
#5	Single flash - Alternate	#15	Twelve flash
#6	Double flash - Alternate	#16	Single flash - Accelerate
#7	Quad flash - Alternate	#17	Double flash - Accelerate
#8	Octa flash - Alternate	#18	SOS
#9	Single flash - Slow	#19	Steady on
#10	Single flash (Breath-like)		/

## WIRING

**RED**..... +VDC (Control high intensity)

**BLACK**.....-GROUND

**WHITE**..... Constantly connect to Red wire to achieve low power

**YELLOW**.....Pattern Selection + Synchronization

(1) Pattern Selection - Apply Yellow to **Red wire**

.....Less than 1s for next pattern

..... 1 to 3s for previous pattern

.....3 to 5s back to #1

.....Over 5s for low power, 5s again to resume power

(2) Synchronization: Connect yellow wires of all heads together for synchronization

**GREY**..... Alternate Selection

① Firstly, connect yellow wires of all heads together.

② Secondly, connect grey wires of Group A and constantly connect to Red wire, and leave others as Group B. Then Group A and B will achieve alternate flash.

③ Disconnecting grey wire will be back to synchronization.

## Bracket installation

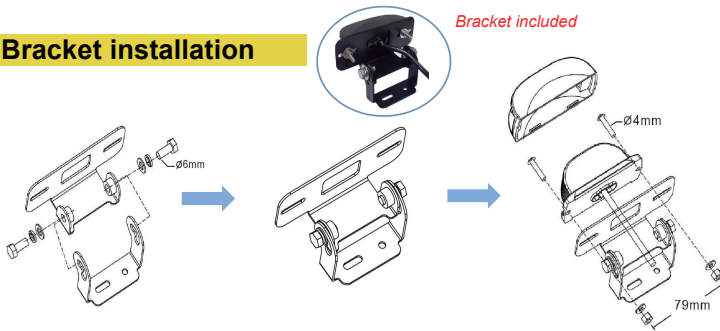

1. Install the screws and nuts on the bracket;
2. Put the bracket at the back side of the lighthouse;
3. Adjust the position of brackets as necessary, and tighten them via spanner;
4. Mounting the lighthouse on the vehicle via screws.

\*Note:Both self-tapping & round head screws can be chosen for mounting based on customers' need

## Approved Mounting Position

**Category 'HT'- 270° Warning Coverage  
(2 units at the front or rear vehicle)**

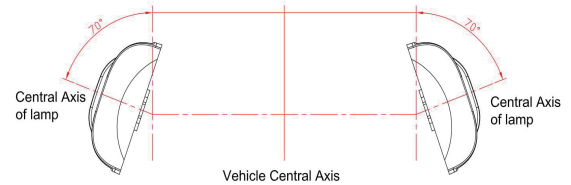

**Category 'T'- 360° Warning Coverage  
(4 units mounted on the vehicle)**

